



CLIMB ON

CLAW INSTALLATION

READ THESE INSTRUCTIONS COMPLETELY BEFORE YOU START. IF YOU DON'T UNDERSTAND THESE INSTRUCTIONS, PLEASE CALL 800-453-1192 FOR ASSISTANCE

Procedure for Installing the Claw on Little Giant Ladder System **SumoStance** and **Lunar** Ladders.

1. Failure to comply with all instructions may result in serious injury.
2. Make sure this kit is compatible with your ladder. If you have any questions concerning the use of this kit on Little Giant Ladder Systems products, call 800-453-1192 for assistance.
3. Before installing this kit, identify all kit components. If any components are missing or damaged, please contact Customer Care. Do not substitute any components.
4. Inspect the ladder before installing this kit. Repair or replace any damaged or missing ladder parts before using the ladder. Use only Little Giant Ladder Systems repair or replacement parts. If you are unable to repair it, discard the ladder.

TOOLS NEEDED



Drill

3/16" Punch



3/16" Drill Bit
13/64" Drill Bit
21/64" Drill Bit

(2) 7/16" Wrenches
(2) 1/2" Wrenches



Hammer

Rivet gun



Chisel

5/32" Allen Wrench



NOTE: IF ANY OTHER PART OF THE LADDER IS DAMAGED BEFORE OR DURING THE PROCESS OF REPLACING THE BAR, DISCARD THE LADDER OR CONTACT CUSTOMER CARE FOR INSTRUCTIONS. **DO NOT USE A DAMAGED LADDER!**

80299 v4 6.16 (1)

COMPONENTS IN KIT

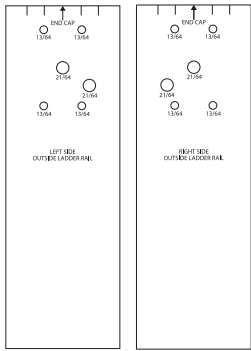

(2) Paper Templates



(2) Springs



(2) Push Pin Stops



(2) Claw Lock



(2) 5/16" Hex Head Bolts



(1) Bar

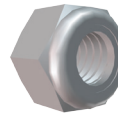

(2) 5/16" Unitorque Lock Nuts



(4) 1/4" Short Hex Head Bolts



(2) Backing Plates



(4) 5/16" Washers

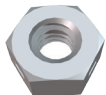

(6) 1/4" Center Lock Nuts



Rubber-lined Cable
Hook/V-rung Assembly



(2) Claw Mounting Brackets



(8) 3/16" Long Rivets



(8) 3/16" Short Rivets



(2) 1/4" Long Hex Head Bolts



(2) 5/16" Socket
Head Shoulder Bolts



(2) Spacers



(8) 5/16" Washers



(1) Chain Assembly
(included in Limited Fall
Arrest System kits only)

***IF YOUR LADDER HAS A TRADITIONAL CABLE HOOK/V-RUNG ASSEMBLY, REMOVE IT BY FOLLOWING THE PROCEDURE BELOW IN STEPS 1-3. IF YOUR LADDER DOES NOT HAVE A CABLE HOOK/V-RUNG ASSEMBLY, PROCEED TO STEP 4.**

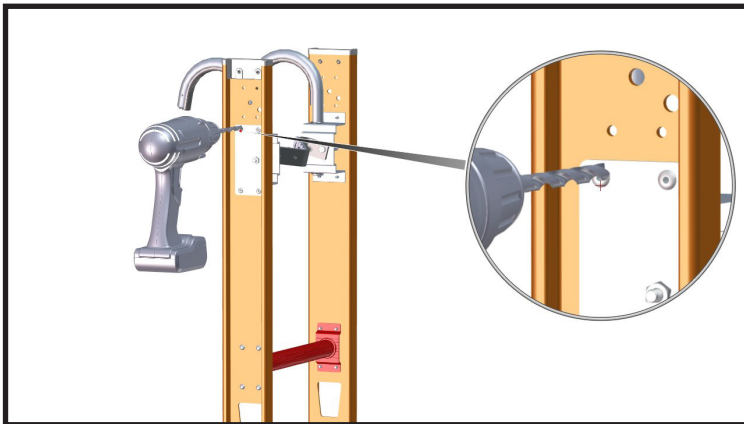

1. Using a 3/16" drill bit making sure the drill bit is centered on the rivet head drill through only the thickness of the rivet head.

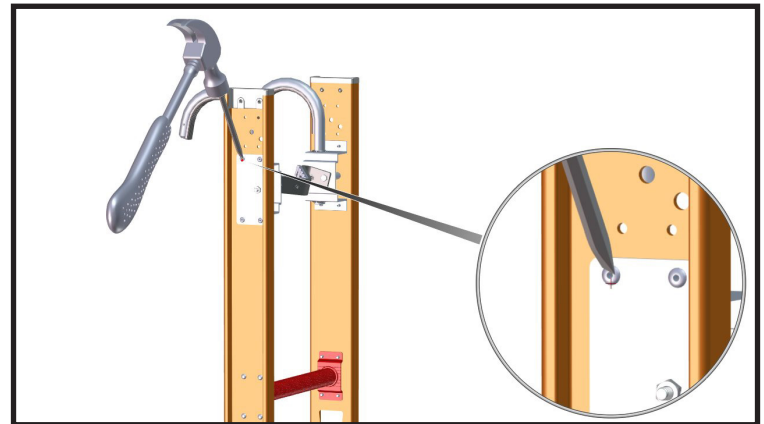

2. If necessary, use a hammer and chisel to remove the remaining rivet head. Keep the chisel parallel to the ladder side rail to prevent damage to the fiberglass.

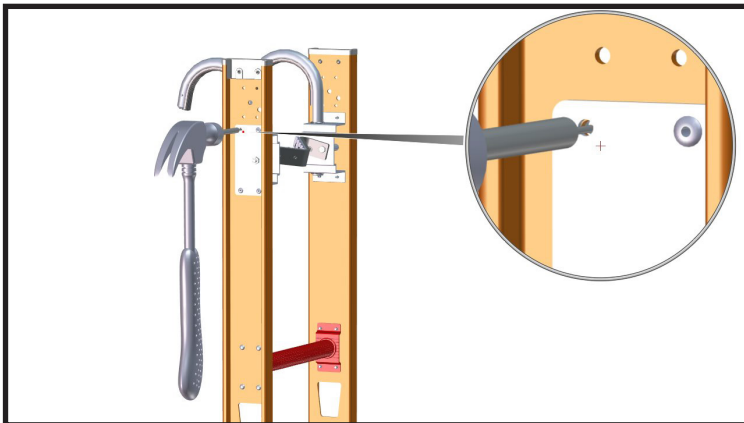

3. With the rivet head removed, tap the remaining rivet shank through the side rail using a hammer and 3/16" diameter punch. Repeat procedure for all 8 rivets attaching the Cable Hook/V-rung Assembly to the ladder side rails.

(Left side rail as you face the climbing side of the ladder)

*Align top edge of template here

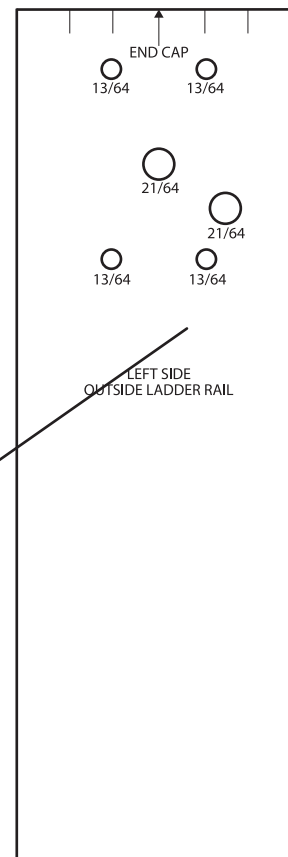
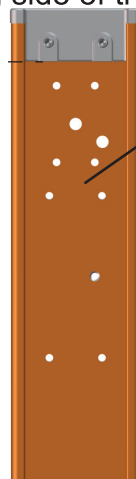

4. Align the top edge of the template with the bottom of the black plastic end cap, and center left-to-right on the rail. Tape the template securely in place to the outside of the ladder rail. Drill through the (4) 13/64" diameter holes, then drill through the (2) 21/64" diameter holes. Repeat the procedure for the other side rail.

***IMPORTANT: MAKE SURE YOU ORIENT THE LEFT SIDE TEMPLATE ON THE LEFT RAIL OF THE LADDER AND THE RIGHT SIDE TEMPLATE ON THE RIGHT RAIL OF THE LADDER.**



5. Align the holes on the top of the Claw Locks to the Bar, fit so that the Bar is located on the inside of the Claw Locks.

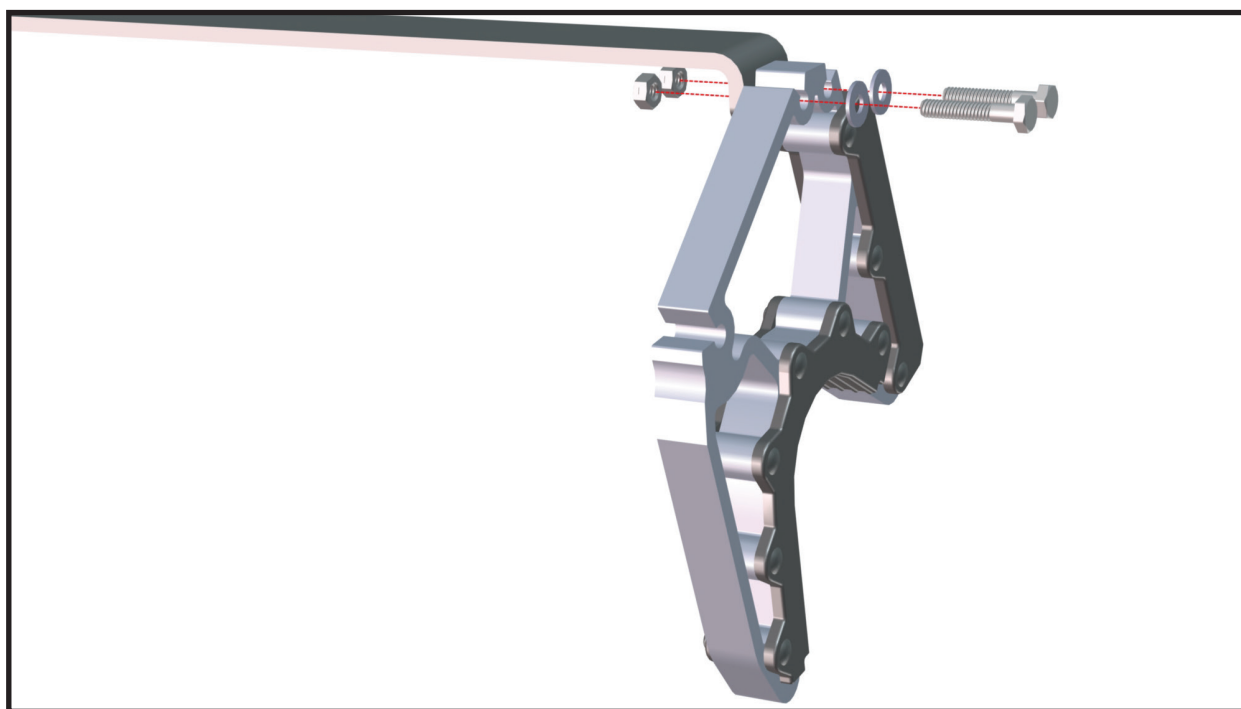

6. Insert the (4) 1/4" Hex Head Bolts through the washers, then through the top of the Claw Locks and through the Bar. Tighten the (2) 1/4" Hex Center Lock Nuts using (2) 7/16" Wrenches. *Repeat on other side.

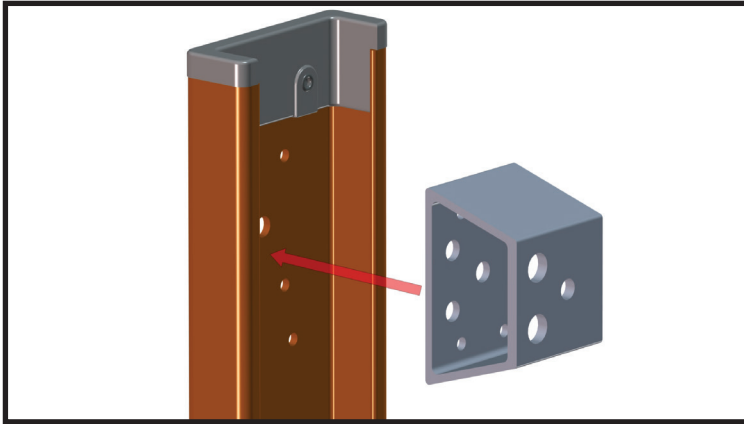

7. Line up Claw Mounting Brackets with the newly drilled holes, Making sure all of the $\frac{21}{64}$ " holes line up with the holes in the rail.

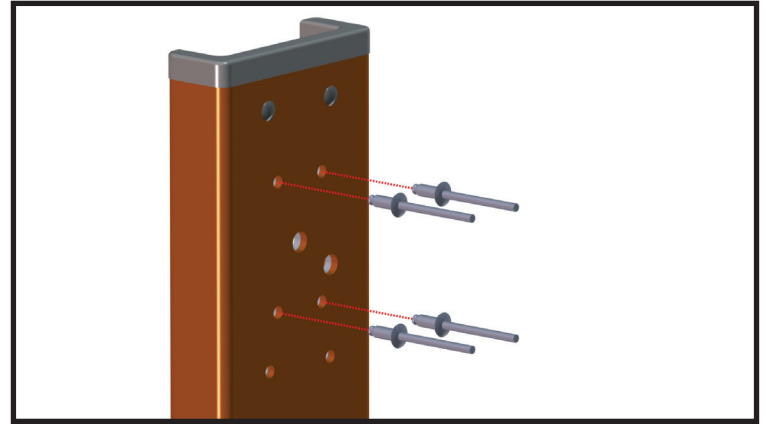

8. Insert $\frac{3}{16}$ " Short Rivets into holes, as shown above. Set with a Rivet Gun. *Repeat on opposite side.

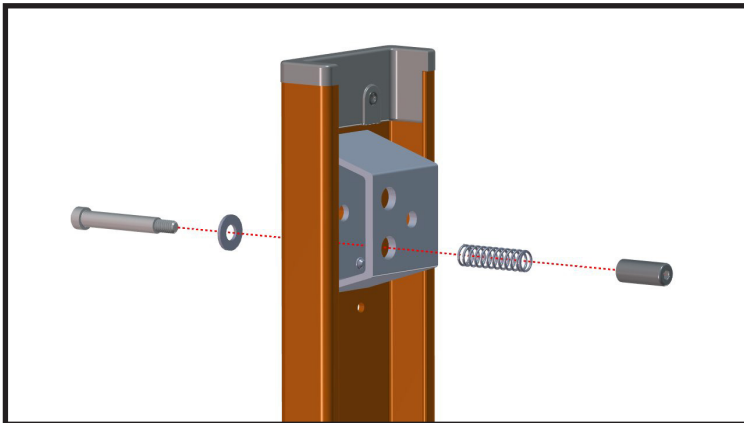

9. Place a $\frac{5}{16}$ " Washer onto the $\frac{5}{16}$ " Socket Head Shoulder Bolt, then insert the bolt through the Claw Mounting Bracket, as shown. Place a Spring onto the shaft of the bolt then screw on the Push Pin Stop with a $\frac{5}{32}$ " Allen wrench until tight. *Repeat on opposite side.

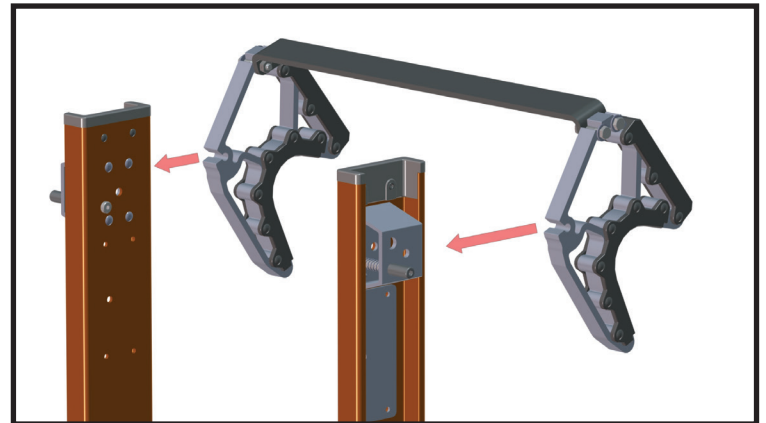

10. Align the assembled Claw and slide onto the exterior of the ladder, as shown.

11. Place a $\frac{5}{16}$ " Washer onto a $\frac{5}{16}$ " Hex Head Bolt, insert into the Claw Lock and through the Claw Mounting Bracket, making sure there is a washer between the gripper and the bracket. Place another $\frac{5}{16}$ " washer on the inside of the rail then attach a $\frac{5}{16}$ " Unitorque Lock Nut using two $\frac{1}{2}$ " wrenches. *Repeat on opposite side.

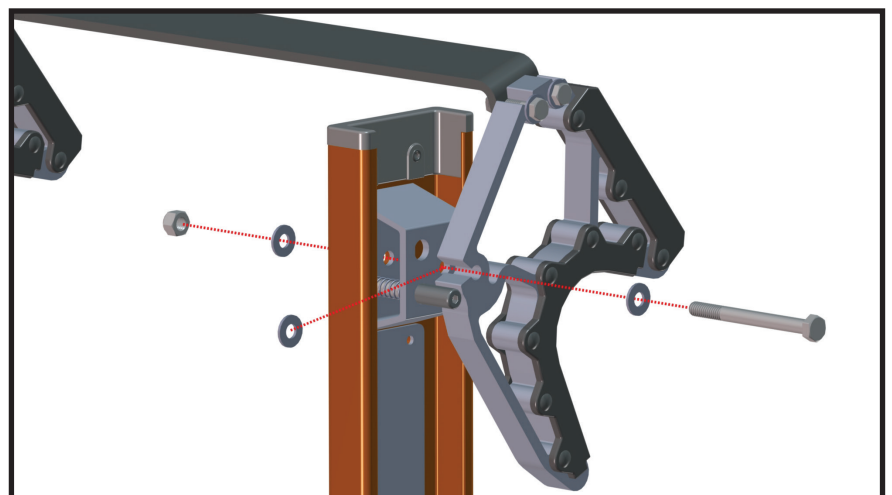

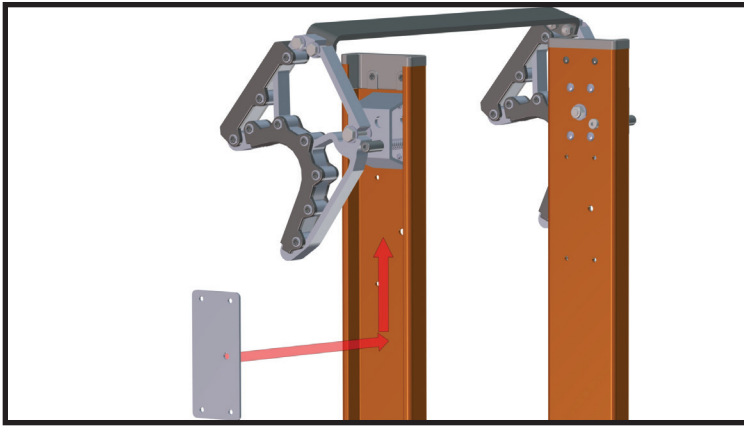

12. Take the Backing Plate and place it against the outside of the ladder rail and make sure all five holes line up.

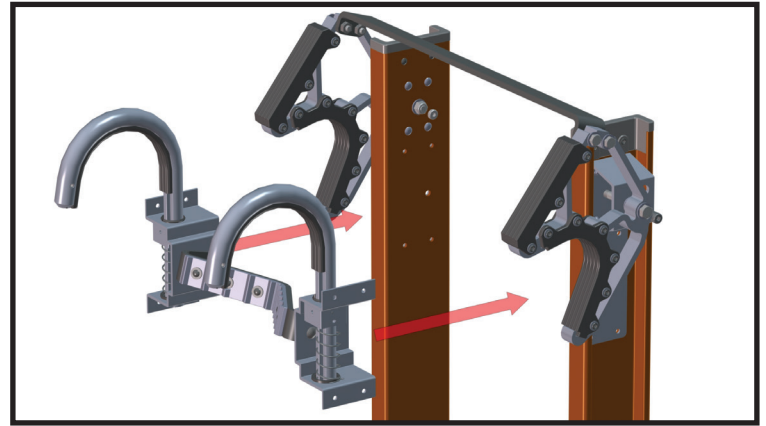

13. Slide the Rubber-lined Cable Hook/V-rung Assembly into the interior of ladder and line up holes, as shown.

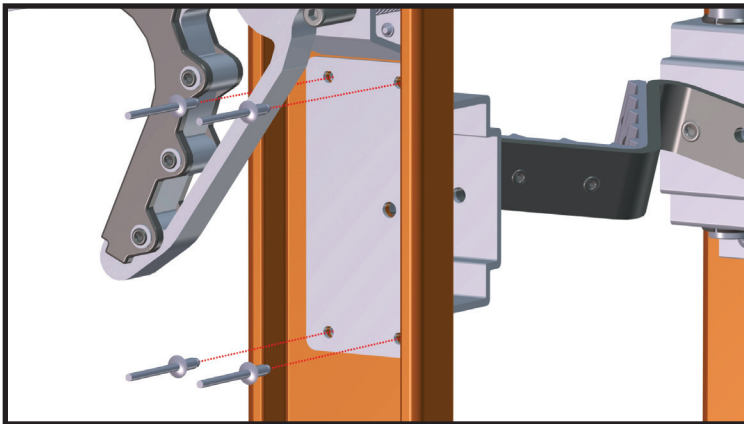

14. Insert 3/16" Long Rivets and set with a Rivet Gun.
*Repeat steps 12–14 on opposite side.

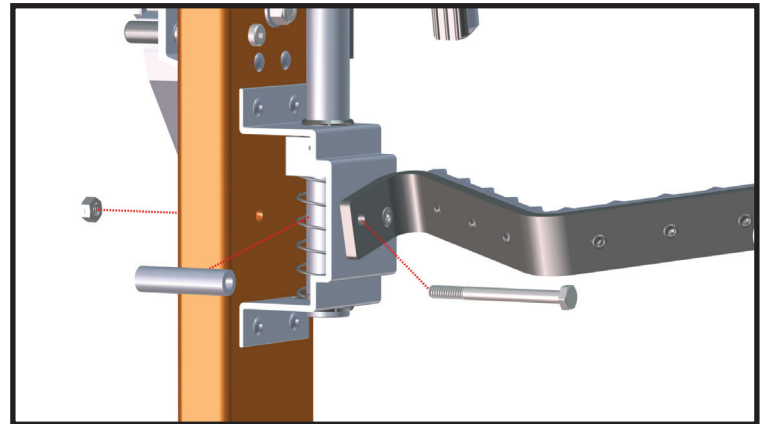

15. Insert Spacer between the Cable Hook/V-rung Assembly and side rail, then insert 1/4" Hex Head Bolt through the Cable Hook/V-rung Assembly, the Spacer, and side rail. Tighten with a 1/4" Center Lock Nut. *Repeat on opposite side.

****STEPS 16 & 17 ARE FOR LIMITED FALL ARREST KITS ONLY****

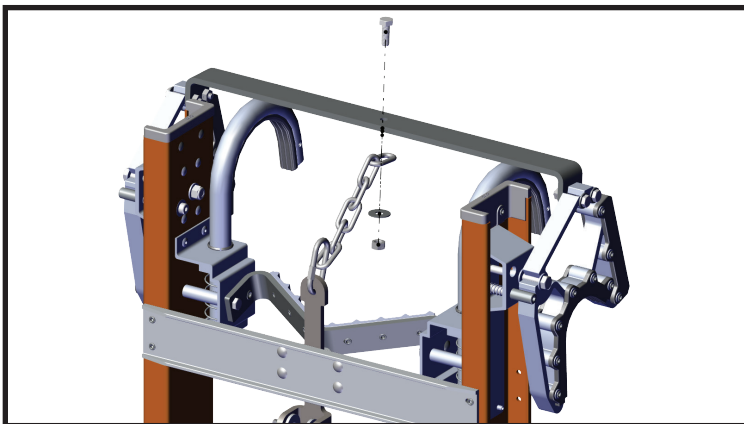

16. If you have a Limited Fall Arrest System on your ladder, connect the Quick Link connector through the top of the sliding pulley assembly, and then attach the chain with the provided fasteners as shown.

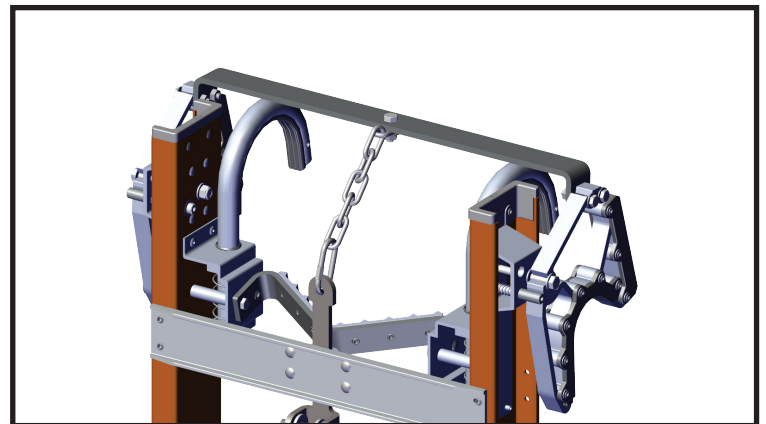

17. The Limited Fall Arrest System is now ready for use.

***IMPORTANT: DOUBLE-CHECK THAT ALL THE FASTENERS ARE TIGHT AND THE LADDER IS SECURE BEFORE RETURNING THE LADDER TO SERVICE.**

